



Industrial Air Circulator Instructions

For All Utility Fan Models

READ AND SAVE THESE IMPORTANT INSTRUCTIONS

It is important that the following safety precautions be followed when using this product:

- ALWAYS unplug unit for cleaning or maintenance.
- ALWAYS unplug unit when not in use.
- ALWAYS unplug when moving unit from one location to the next.
- DO NOT use an extension cord. Plug fan into a properly rated electrical outlet.
- DO NOT place foreign objects through guards into blades.
- DO NOT allow unit to become wet or damp.
- DO NOT use this fan with any solid state speed control device.
- DO NOT operate any fan with a damaged cord or plug. Discard fan or return to an authorized service facility for examination and/or repair.
- DO NOT run cord under carpeting.
- DO NOT cover cord with throw rugs, runners, or similar coverings.
- DO NOT route cord under furniture or appliances. Arrange cord away from traffic area and where it will not be tripped over.

“NOT SUITABLE FOR USE WITH SOLID-STATE SPEED CONTROLS”

“AVERTISSEMENT; NE CONVIENT PAS A DES REGULATEURS DE VITESSE A SEMI-CONDUCTEURS”

WARNING: To reduce the risk of fire, electrical shock, or injury to persons, observe the following:

- Use this unit only in the manner intended by the manufacturer. If you have questions, contact the manufacturer.
- Before servicing or cleaning unit, switch power off at service panel and lock service panel to prevent power from being switched on accidentally. When the service disconnecting means cannot be locked, securely fasten a prominent warning device, such as a tag to the service panel.
- Do not use replacement parts that have not been recommended by the manufacturer (e.g. parts made at home using a 3D printer).

Avertissement: Pour reduire les risques d'incendie ou de choc electrique, ou de blessures, respectez les consignes suivantes:

- Utiliser cette unite uniquement de laniere prevue par le fabricant. Si vous avez des questions, contactez le fabricant.
- Avant de reparer ou nettoyer l'appareil, couper le courant au panneau de service et verrouiller a pevent sa remise en marche accidentelle. lorsque la moyenne de la deconnexion n'est pas bloque, fixez solidement un avertissement bien en evidence, comme une etiquette sur le panneau de service.
- N'utilisez pas de pieces de rechange qui n'ont pas été recommandées par le fabricant.

INSTALLATION INSTRUCTIONS

For installation on wood structures, use a 1/2" lag screw of appropriate length for the application.

For installation on steel structures, use a 1/2" bolt of the appropriate length for the application, in combination with a flat washer, a lock washer and a 1/2" nut.

For installation on masonry structures, use a 1/2" lag screw, in combination with a lag shield, of appropriate length for the application.

In all cases, it is recommended that a flat washer be placed on both sides of the fan yoke to assist in smooth rotation.

OPERATING INSTRUCTIONS

This unit is equipped with a three (3) speed selector switch, which allows you to select a desired amount of air delivery. During normal operation it is not uncommon for the motor to be warm to the touch. The motor is equipped with a thermo-protector, and will automatically d-energize the fan if it were to over heat for any reason. If this should happen immediately disconnect unit from power outlet.

MODEL								QTY	TPI P/N	DESCRIPTION
U 12	U 18	U 18-TE	U 12-TE	U 18-TE27	U-24-TE	MP-783P CARRIAGE	MP-783R CARRIAGE			
VARIATION										
-001	-002	-003	-004	-005	-006	-007	-008			
X	X	X	X	X	X	X	X	1	58056-011	YOKE
X	X	X	X	X	X	X	X	1	58056-012	YOKE
X	X	X	X	X	X	X	X	1	58056-013	YOKE
X	X	X	X	X	X	X	X	1	63754-001	FRONT GUARD
X	X	X	X	X	X	X	X	1	63755-001	FRONT GUARD
X	X	X	X	X	X	X	X	1	63761-001	FRONT GUARD
X	X	X	X	X	X	X	X	1	63988-001	FRONT GUARD
X	X	X	X	X	X	X	X	1	63990-001	FRONT GUARD
X	X	X	X	X	X	X	X	1	63993-001	FRONT GUARD
X	X	X	X	X	X	X	X	1	63989-001	REAR GUARD
X	X	X	X	X	X	X	X	1	63991-001	REAR GUARD
X	X	X	X	X	X	X	X	1	63992-001	REAR GUARD
X	X	X	X	X	X	X	X	1	63753-001	REAR GUARD
X	X	X	X	X	X	X	X	1	63756-001	REAR GUARD
X	X	X	X	X	X	X	X	1	63870-001	REAR GUARD
X	X	X	X	X	X	X	X	1	58061-001	MOTOR
X	X	X	X	X	X	X	X	1	58043-001	MOTOR
X	X	X	X	X	X	X	X	1	58158-001	MOTOR, TOTALLY ENCLOSED
X	X	X	X	X	X	X	X	1	58181-001	MOTOR, TOTALLY ENCLOSED
X	X	X	X	X	X	X	X	1	58186-001	MOTOR, TOTALLY ENCLOSED, 277V
X	X	X	X	X	X	X	X	1	58364-002	MOTOR, TOTALLY ENCLOSED
X	X	X	X	X	X	X	X	1	58061-003	MOTOR, TOTALLY ENCLOSED
X	X	X	X	X	X	X	X	1	58478-001	FAN BLADE ASSEMBLY
X	X	X	X	X	X	X	X	1	58299-008	FAN BLADE ASSEMBLY
X	X	X	X	X	X	X	X	1	29904-017	FAN BLADE ASSEMBLY
X	X	X	X	X	X	X	X	1	43886-001	CENTER LOGO PLATE
X	X	X	X	X	X	X	X	1	43901-001	CENTER LOGO PLATE
X	X	X	X	X	X	X	X	1	43887-001	CENTER LOGO LABEL
X	X	X	X	X	X	X	X	1	43902-001	CENTER LOGO LABEL
X	X	X	X	X	X	X	X	1	44122-001	CENTER LOGO LABEL
X	X	X	X	X	X	X	X	1	43883-001	SWITCH PLATE LABEL
X	X	X	X	X	X	X	X	1	43883-003	SWITCH PLATE LABEL
X	X	X	X	X	X	X	X	1	58071-001	SWITCH
X	X	X	X	X	X	X	X	1	58573-001	SWITCH
X	X	X	X	X	X	X	X	1	58047-001	CORD SET ASSEMBLY
X	X	X	X	X	X	X	X	1	43882-001	STRAIN RELIEF
X	X	X	X	X	X	X	X	2	42502-001	BOLT, 1/4"-20 X 1.250" CARRIAGE
X	X	X	X	X	X	X	X	2	43884-001	RUBBER BUSHING
X	X	X	X	X	X	X	X	2	4901	NUT, 1/4"-20 HI-CROWN NYLOCK
X	X	X	X	X	X	X	X	4	3904	NUT, #8-32 NYLOCK
X	X	X	X	X	X	X	X	2	3377	NYLON TY-RAP
X	X	X	X	X	X	X	X	1	3159	#6 X 1/4 TYPE A SCREW

⊗ DENOTES ITEM REQUIRED FOR THAT MODEL

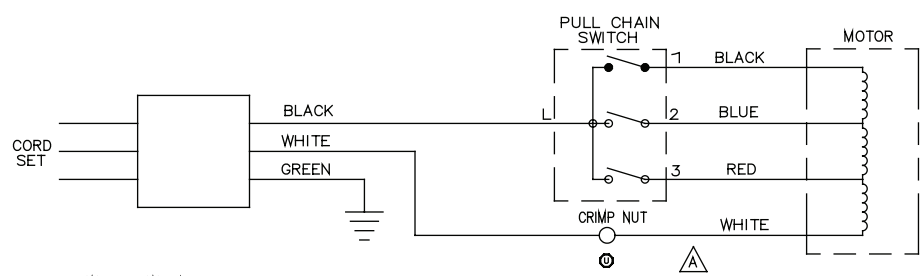
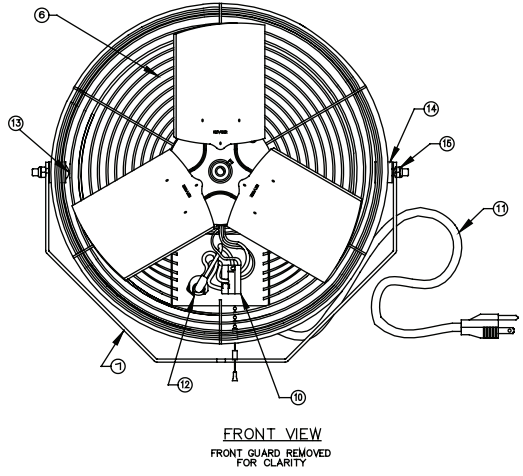
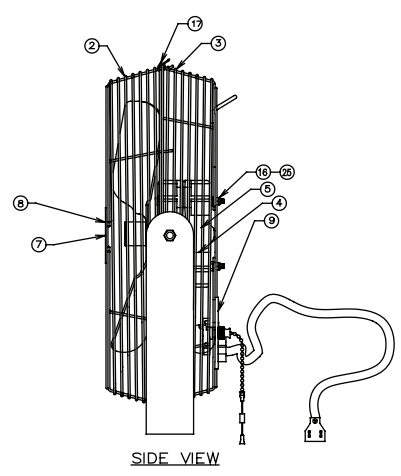

L = CORD, BLACK
 1 = MOTOR, BLACK
 2 = MOTOR, BLUE
 3 = MOTOR, RED
 SPICER = MOTOR/CORD, WHITE
 TAB ON SWITCH PLATE = GREEN GROUND
 ATTACH WITH ITEM #18.

CLEANING/MAINTENANCE INSTRUCTIONS

All maintenance should be done by either TPI Corporation or a qualified electrician. The motor bearings are lubricated at the factory and should not require any additional lubrication. However, if bearing lubrication is required, apply a small amount of a synthetic oil to the motor bearing.

Remove two retaining screws and open the six guard clips on the flange. Lift front guard up and off to separate the two halves. Use mild detergent to clean the blade and guards. Avoid allowing cleanser to come in contact with the motor windings or bearing. Then replace front guard in reverse order of disassembly. Allow fan to dry completely before next use.

Save these important instructions. Your TPI Air Circulator carries a one year warranty.

For additional information on TPI Products or replacement parts, call TPI Customer Service Department at 1-800-251-0382 or write the address below.

PO. Box 4973 • Johnson City, Tennessee 37602-4973 • 423-477-4131 • FAX 423-477-0683